



- 阻值范围宽 Wide resistance range
- 厚膜、无感设计 Thick film, non-inductive design
- 适用于变速驱动、自动控制、控制设备、以及高频电路和终端电路
Used in speed drivers, auto control device, control device, high frequency and terminal circuits

RMG25 功率型塑封电阻器 RMG25 Power type, plastic sealed resistor

■ 适用标准 Applicable specifications

- GB/T5729-2003 电子设备用固定电阻器 第一部分: 总规范
- Q/RU457-2011 RMG25 功率型塑封电阻器详细规范

■ 主要技术指标 Technical and standard electrical specifications

- 阻值范围 Resistance range: 10Ω~1MΩ
- 阻值允许偏差 Resistance tolerance: ±5%
(Tolerance within ±1%~±10% available upon request)
- 额定功率 Rated power: 25W (电阻局部最高温度≤125°C)
(Maximum local temperature≤125°C)
- 电阻温度系数 TCR: ≤±150×10⁻⁶/°C
- 最大工作电压 Maximum working voltage: 550V
- 最大过载电压 Maximum overload voltage: 1100V
- 耐电压 (50Hz, I_{max}:10mA) Voltage proof: 3500V_{AC}
- 绝缘电阻 (500V) Insulation voltage: ≥1GΩ
- 工作温度范围 Working temp: -55°C~125°C
- 气候顺序 Climatic sequence: 55/125/56
- 电阻安装 M3 螺丝, Screws

■ 降功耗曲线 Derating

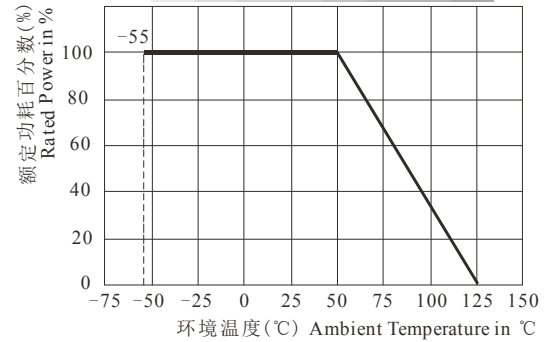

■ 外形尺寸图 Dimensions

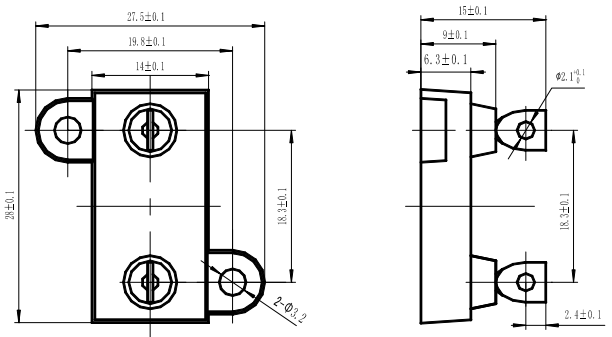

公差: 除注明外均为±0.3mm
Note: Tolerance is ±0.3mm, unless otherwise specified

■ 主要检验项目、检验方法及性能要求 Performance

检验项目 Test	检验方法 Conditions of test	性能要求 Test limits
瞬时过载 Transient overload	2U _R or 2U _{max} 取较小者, Whichever smaller 5s	ΔR≤±(0.25%R+0.05Ω)
温度冲击 Thermal shock	-55°C /+125°C, 5 cycles	
寿命 Load life	U _R ,1000h,环境温度,Ambient temperature 25°C	ΔR≤±(0.5%R+0.05Ω)
稳态湿热 Damp heat, Steady state	40°C, RH:90%~95%,56 days	
气候顺序 Climate category	(55/155/56)	ΔR≤±(1%R+0.05Ω)

■ 订货指南 Ordering information

RMG25 - 25W - 10KΩ - J

型号 Type - 额定功率 Rated power - 标称阻值 Nominal resistance - 允许偏差 Tolerance

对于本页内容的任何变更, 恕不另行通知。订货前, 请确认技术参数。Specifications are subject to change without notice.